

Always here to help you / 始终如一地为您提供帮助

Register your product and get support at / 请登录以下网址并得到相应的帮助
www.philips.com/welcome

QC5570



User manual / 用户手册

PHILIPS



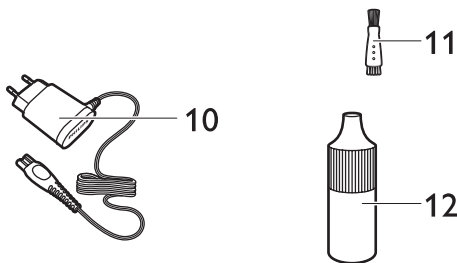
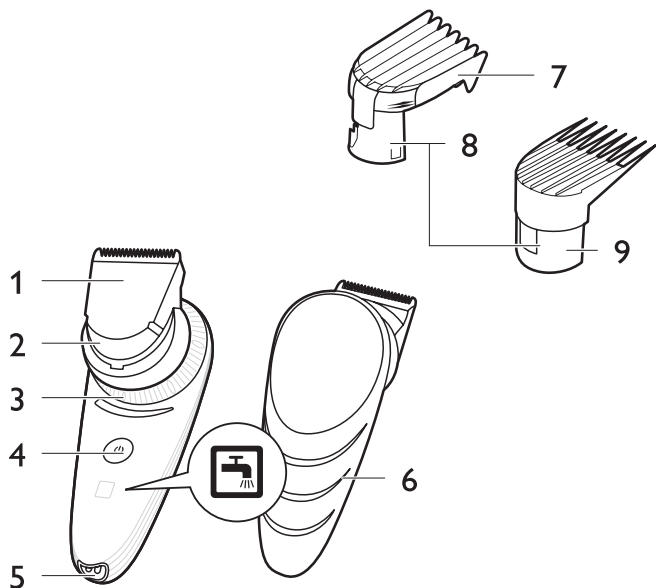

ENGLISH 6

简体中文 17

Introduction

Congratulations on your purchase and welcome to Philips! To fully benefit from the support that Philips offers, register your product at www.philips.com/welcome.

Your new Philips hair clipper with new ergonomic design and 180° adjustable cutting element allows you to clip your own hair easily. You can move the clipper over all areas of your head as easily as running your fingers through your hair. To enjoy using the hair clipper, we advise you to read the following information.

General description (Fig. 1)

- 1 Cutting element
- 2 Swivel head
- 3 Length setting adjustment ring
- 4 On/off button
- 5 Socket for small plug
- 6 Charging lights
- 7 Precision comb attachment
- 8 Length setting indicator
- 9 Regular comb attachment
- 10 Adapter
- 11 Cleaning brush
- 12 Oil

Important

Read this user manual carefully before you use the appliance and save it for future reference.

Danger

- Make sure the adapter does not get wet.

Warning

- The adapter contains a transformer. Do not cut off the adapter to replace it with another plug, as this causes a hazardous situation.
- This appliance is not intended for use by persons (including children) with reduced physical, sensory or mental capabilities, or lack of experience and knowledge, unless they have been given supervision or instruction concerning use of the appliance by a person responsible for their safety.
- Keep the appliance and its cord out of the reach of children.

Caution

- Do not use the appliance in the bath or in the shower.
- Use, charge and store the appliance at a temperature between 5°C and 35°C.
- Only use the adapter supplied to charge the appliance.
- If the adapter is damaged, always have it replaced with one of the original type in order to avoid a hazard.
- Do not use the appliance when the shaving head, the cutting element or one of the comb attachments is damaged or broken, as this may cause injury.
- This appliance is only intended for clipping human scalp hair. Do not use it for any other purpose.
- If the appliance is subjected to a major change in temperature, pressure or humidity, let the appliance acclimatise for 30 minutes before you use it.



Compliance with standards

- The appliance complies with the internationally approved IEC safety regulations and can be safely cleaned under the tap.
- This Philips appliance complies with all standards regarding electromagnetic fields (EMF). If handled properly and according to the instructions in this user manual, the appliance is safe to use based on scientific evidence available today.

Before first use



- 1** Pull the front of the cutting element upwards (1) and remove the cutting element from the appliance(2).

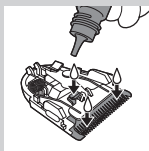

- 2** Turn the cutting element and lubricate the three points indicated with oil from the oil bottle supplied.

Charging

Charge the appliance for at least 1 hour before you use it for the first time or after a long period of non-use.

When the appliance is fully charged, it has a cordless clipping time of up to 1 hour.

When the charging light flashes orange, the battery is running low (approx. 10 minutes of operating time left) and you need to charge the appliance.

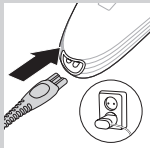

- 1** Make sure the appliance is switched off.
- 2** Insert the appliance plug into the appliance and insert the adapter into the wall socket.

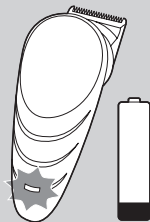

- ▶ The charging light starts to flash white to indicate that the appliance is charging.
- ▶ When the battery is fully charged, the charging light lights up white continuously.
- ▶ After approx. 30 minutes the charging light goes out to save energy.

Optimising the lifetime of the rechargeable battery

Discharge the rechargeable battery completely twice a year by letting the motor run until it stops. Then fully recharge the battery.

Corded clipping

- 1** Switch off the appliance.
- 2** Connect the appliance to the mains and wait a few seconds before you switch it on.

Note: If the battery is completely empty, wait a few minutes before you switch on the appliance.

Using the appliance

Make sure your hair is clean and dry. Do not use the appliance on freshly washed hair.

Preparing for hair clipping



- 1 Comb your hair with a styling comb in the direction of hair growth.

Clipping with comb attachment

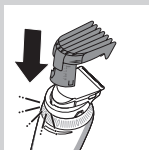

- 1 Insert the edge of the comb attachment into the swivel head.
Make sure the comb attachment locks into position properly

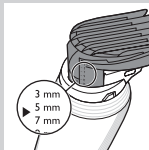

Note: The length settings are indicated on the comb attachment.

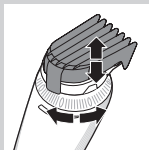

- 2 Turn the length setting adjustment ring to set the comb attachment to the desired setting.
The arrowhead on the appliance indicates which setting you have selected.



Tip: Use different settings to create a natural and smooth transition between the various hair lengths from your neckline to the top of your head.

Do not turn the length setting adjustment ring beyond the highest setting.

- 3** Turn the swivel head to the position that is most comfortable for your arm when you clip the different parts of your head.

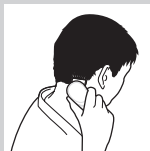
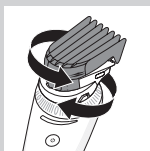
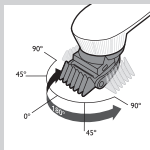

Using the swivel head

- From its starting position of 0° (pointing forwards), you can turn the swivel head 45° or 90° to the left or right. This enables you to adjust the position of the cutting element to the part of your head that you are clipping. This makes it much easier to clip your own hair.
- To set the cutting element to the desired position, turn the swivel head ('click').

Note: Always adjust the position of the cutting element by turning the swivel head. Do not turn the cutting element or the comb attachment.

Note: Do not turn the swivel head more than 90° to the left or right.

- The swivel head allows you to hold and use the appliance like a styling comb.

- 4** Press the on/off button to switch on the appliance.

QC5570: Press the button briefly.

QC5580: Press the button for 2 seconds.

- 5** Move the clipper through the hair slowly.

- 6** Regularly remove cut hair from the comb attachment.

If a lot of hair has accumulated in the comb attachment, remove the comb attachment from the appliance and blow and/or shake the hair out of it. When you remove the comb attachment, the selected setting does not change.

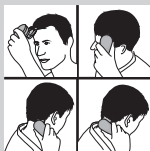

Tips

- We advise you to start clipping at the highest setting of the regular comb attachment and to reduce the setting gradually.
- To clip most effectively, move the appliance against the hair growth direction.
- Since all hair does not grow in the same direction, you need to move the appliance in different directions (upwards, downwards and across).
- Make sure that the flat part of the comb attachment is always fully in contact with the scalp to obtain an even result
- Write down the settings you use to create a certain hairstyle as a reminder for future clipping sessions.

Contouring without comb attachment

You can use the appliance without comb attachment to clip your hair very close to the skin (0,5mm) or to contour the neckline and the area around the ears.

Be careful when you clip without comb attachment because the cutting element removes every hair it touches.

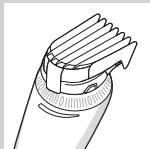

- 1** Pull the comb attachment off the swivel head.

Never pull at the flexible top of the comb attachment. Always pull at the bottom part.

- 2** Comb the hair ends over the ears before you start to contour the hairline.

- 3** Press the on/off button to switch on the appliance.

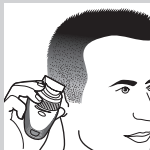

- 4** When you shape the contours around the ears, tilt the appliance in such a way that only one edge of the cutting element touches the hair ends.

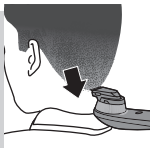

- 5** To contour the neckline and the sideburns, turn the appliance and make downward strokes.

Note: Move the appliance slowly and smoothly. Just follow the natural hairline.

- 6** Adjust the position of the swivel head to make contouring easier.

Cleaning and maintenance

Clean the appliance every time you have used it by rinsing it under the tap or with the cleaning brush supplied.

Never use compressed air, scouring pads, abrasive cleaning agents or aggressive liquids such as petrol, acetone or ethereal oils to clean the appliance.

Be careful that the cutting element does not fall on the floor.

Cleaning the cutting element and comb attachments

- 1** Switch off the appliance and disconnect it from the mains.
- 2** Remove the comb attachment.
- 3** Rinse the comb attachment under the tap or clean it with the cleaning brush supplied.

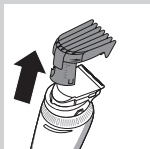

- 4** Place your thumb in the center of the round side of the cutting element and your index finger on the teeth of the cutting element (1). Use your index finger to lift the cutting element from the swivel head (2).

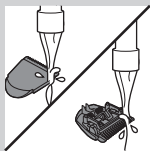

- 5** Rinse the cutting element under the tap or clean it with the cleaning brush supplied.

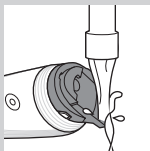

- 6** Rinse the inside of the appliance under the tap or clean it with the cleaning brush supplied.



- 7** Insert the lug of the cutting element into the slot (1) and push the cutting element back onto the swivel head (2).

Lubrication

Lubricate the clipping element every 3 months with oil from the bottle supplied with the appliance.

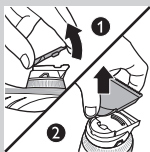

- 1** Pull the front of the cutting element upwards (1) and remove the cutting element from the appliance (2).

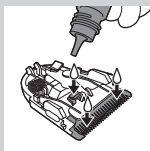

- 2** Turn the cutting element and lubricate the three points indicated.

Storage

- 1** Switch off the appliance and disconnect it from the mains.
- 2** Store the appliance and its accessories in the storage pouch supplied.

Environment



- Do not throw away the appliance with the normal household waste at the end of its life, but hand it in at an official collection point for recycling. By doing this, you help to preserve the environment.



- The built-in rechargeable battery contains substances that may pollute the environment. Always remove the battery before you discard and hand in the appliance at an official collection point. Dispose of the battery at an official collection point for batteries. If you have trouble removing the battery, you can also take the appliance to a Philips service centre. The staff of this centre will remove the battery for you and will dispose of them in an environmentally safe way.

Removing the rechargeable battery

Only remove the rechargeable battery when you discard the appliance. Make sure the battery is completely empty when you remove it.

Do not connect the appliance to the mains again after you have removed the rechargeable battery.

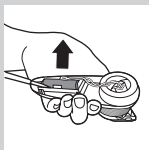
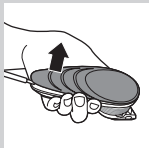

- 1** Disconnect the appliance from the mains and let the appliance run until the motor stops.
- 2** Remove the upper housing part of the appliance.
- 3** Open the inner body with a screwdriver.
- 4** Use a screwdriver to remove the rechargeable battery from the appliance.
- 5** Cut the wires with a pair of household scissors.

Guarantee and service

If you need service or information or if you have a problem, please visit the Philips website at **www.philips.com/support** or contact the Philips Consumer Care Centre in your country. You find its phone number in the worldwide guarantee leaflet. If there is no Consumer Care Centre in your country, go to your local Philips dealer.

简介

感谢您的惠顾，欢迎光临飞利浦！为了您能充分享受飞利浦所提供的支持，请在 www.philips.com/welcome 上注册您的产品。您新购买的飞利浦理发器具有全新人体工学设计和 180° 可调节修剪部件，使您可以轻松为自己修剪头发。您可以将理发器在自己整个头部移动，就像在头发上运动您的手指一样简单。要充分享受理发器的便利，建议您阅读下列信息。

基本说明 (图 1)

- 1 修剪部件
- 2 旋转头
- 3 长度设置调整环
- 4 开/关按钮
- 5 小插头的转换插座
- 6 充电指示灯
- 7 精密梳齿附件
- 8 长度调校指示器
- 9 常规梳齿附件
- 10 适配器
- 11 清洁刷
- 12 油

注意事项

使用本产品之前，请仔细阅读本使用说明书，并妥善保管以备日后参考。

危险

- 确保适配器干燥。

警告

- 电源软线不能更换，如果软线损坏，此器具（电源适配器）应废弃。

- 电源适配器内含有一个变压器。切勿自行更换插头，否则将导致严重后果。
- 肢体不健全、精神有障碍及缺乏相关经验和知识的人（包括儿童）必须在监护人的监督及指导下使用。
- 将产品及其线缆放在儿童接触不到的地方。

注意

- 切勿在洗澡或淋浴时使用本产品。
- 必须在 5 摄氏度至 35 摄氏度之间的温度下使用、存放和为本产品充电。
- 为产品充电，须用随产品提供的电源适配器。
- 如果适配器已损坏，则务必更换原装型号适配器，以免发生危险。
- 如果剃毛刀头、修剪部件或其中一个梳齿附件损坏或损毁，请勿再使用本产品，否则可能对人体造成伤害。
- 本产品仅限于修理人类头发。不可将其用作任何其它用途。
- 如果产品的使用温度、气压或湿度方面改变较大，应在使用之前让产品适应 30 分钟。

符合标准

- 符号注释：适合用在打开的水龙头下进行清洗。
- 此产品符合国际认可的 IEC 安全标准，可放心在自来水龙头下清洗。
- 本飞利浦产品符合电磁场 (EMF) 所有相关标准。就目前的科学研究证明，如果正确使用并按照本用户手册中的说明进行操作，本产品是安全的。



首次使用之前



- 1** 将修剪部件前端向上拉 (1)，然后从产品上取下修剪部件 (2)。

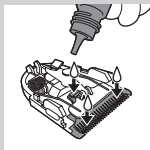

- 转动修剪部件，用随附油瓶中的油润滑所示的三个位置。

充电

首次使用前或长时间不用之后，请为产品至少充电 1 小时。

当产品充满电时，它可在不接电源的情况下修剪长达 1 小时。

如果充电指示灯呈橙色闪烁，表示电池电量不足（还可以使用约 10 分钟），您需要为产品充电。

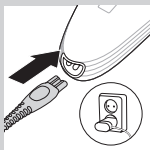

- 确保产品电源已关闭。

- 将插头插入产品中，并将适配器插入插座中。

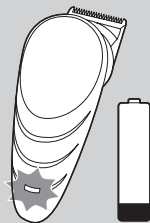

- 充电指示灯开始呈白色闪烁，指示产品正在充电。

- 电池充满电时，充电指示灯将呈白色持续亮起。

- 大约 30 分钟后，充电指示灯熄灭以节省能源。

优化充电电池寿命

每年将充电电池彻底放电两次，方法是让马达一直转动，直到不再转为止。然后将电池再次完全充电。

接电源线修剪

- 关闭产品。

- 将本产品连接到电源，等待几秒钟再启动。

注意：如果电池电量已完全耗尽，请在启动本产品之前等待几分钟。

使用本产品

确保您的头发清洁且干燥。请勿在刚洗过的湿发上使用本产品。

准备头发修剪



- 1 使用定型梳沿头发生长的方向梳理头发。

使用发梳理发

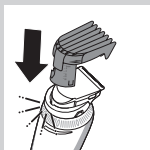

- 1 将梳齿附件的边缘插入旋转头。确保梳齿附件正确锁定到位

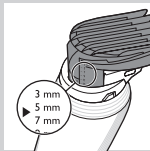

注意：梳齿附件上指示长度设置。

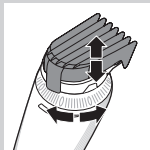

- 2 旋转长度设置调整环，将梳齿附件设为所需设置。
▶ 产品上的箭头表示您选择的设置。



提示：使用不同设置在从颈部到头顶的各种头发长度之间实现自然顺利的过渡。

切勿将长度设置调整环转到最高设置之外。

- 3** 在修剪不同位置的头发时，可以将旋转头转动到您的手臂感觉最舒服的位置。

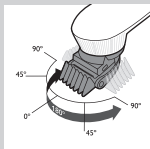

使用旋转头

- 您可以将旋转头从开始位置 0°（指向前方）向左或向右旋转 45° 或 90°。用这种方法，可以将修剪部件的位置调整到要修剪的那部分头发。这使您为自己理发更容易。

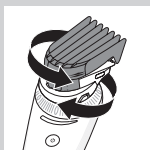

- 要将修剪部件设置到所需位置，请转动旋转头（可听到“咔哒”一声）。

注意：始终转动旋转头调整修剪部件的位置。请勿直接转动修剪部件或梳齿附件。

注意：请勿向左或向右转动旋转头超过 90°。

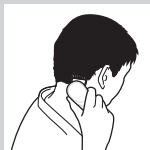

- 旋转头使您能够像握持定型梳一样拿起并使用本产品。

4 按开/关按钮启动产品。

QC5570：短暂地按下按钮。

QC5580：按住按钮 2 秒钟。

5 将理发器在头发上缓慢移动。

6 定期清除梳齿附件中剪下的头发。

如果梳齿附件中积聚了大量的头发，请将梳齿附件从产品中取出，然后将头发吹出或摇出。取出梳齿附件时，选定的设置不会发生更改。

提示

- 建议您从常规梳齿附件的最高设置开始修剪，然后逐渐缩短设置。
- 要获得最大修剪效率，请正对头发生长方向移动本产品。
- 因为头发不会全部以相同的方向生长，您需要以不同的方向移动产品（向上、向下或交叉）。

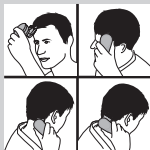

- 确保梳齿附件的扁平部分完全接触到头皮，以获得均匀的修剪效果
- 记下您使用的设置，用作未来剪发过程中创造某种发型的参考。

不用梳齿附件的情况下修整轮廓

即使没有梳齿附件，您也可以使用理发器以非常贴近头皮的距离（0.5 毫米）或紧密贴合颈部周围和双耳附近的皮肤修剪头发。

由于修剪部件会去除接触到的每一根头发，因此在没有梳齿附件修剪头发时要小心。

1 将梳齿附件从旋转头拉出。

切勿拉梳齿附件容易变形的顶部。必须拉底部。

2 沿着耳朵梳理发梢，然后开始修整发际线。

3 按开/关按钮启动产品。

4 修整耳朵周围的轮廓时，倾斜产品，使修剪部件只有一边接触发梢。

5 要修剪颈部周围和鬓角轮廓，请翻转本产品并向下移动。

注意：缓慢平滑地移动产品。顺着自然生长的发际线。

6 调整旋转头的位置，使紧贴轮廓更容易。

清洁和保养

每次用完产品后，请在水龙头下冲洗产品或用随附的清洁刷进行清洁。

切勿使用压缩气体、钢丝绒、研磨性清洁剂或腐蚀性液体（例如汽油、丙酮或香精油）来清洁产品。

小心不要让修剪部件掉落在地板上。

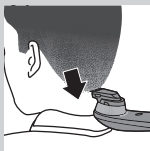
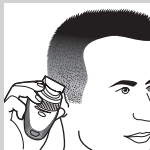
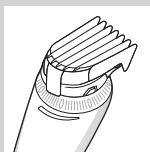

清洁修剪部件和梳齿附件

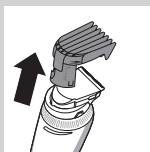

1 关闭产品并断开电源。

2 取下发梳。

3 在水龙头下冲洗梳齿附件或用随附的清洁刷进行清洁。



4 将拇指放在修剪部件的圆边中心，食指放在修剪部件的齿上 (1)。使用食指从旋转头提起修剪附件 (2)。

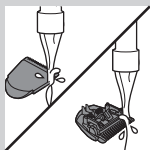

5 在水龙头下冲洗修剪部件或用随附的清洁刷进行清洁。

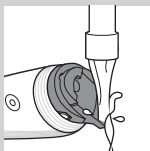

6 在水龙头下冲洗产品的内部或用随附的清洁刷进行清洁。



7 将修剪部件的凸缘插入槽 (1) 内，然后将修剪部件推回旋转头 (2)。

润滑

每 3 个月用产品随附的油瓶中的油润滑一次修剪部件。



- 1 将修剪部件前端向上拉 (1)，然后从产品上取下修剪部件 (2)。

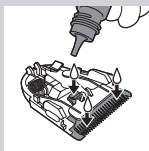

- 2 转动修剪部件并润滑所示的三个位置。

存储

- 1 关闭产品并断开电源。
- 2 将产品及其附件存放在随附的存储袋中。

环保



- 弃置产品时，请不要将其与一般生活垃圾堆放在一起；应将其交给官方指定的回收中心。这样做有利于环保。



- 内置充电电池含有可能会污染环境的物质。丢弃产品时，一定要将电池取出，并将产品送到官方指定的回收站。到官方指定的电池回收站处理电池。如果您在取出电池时遇到问题，您也可以将产品送至飞利浦维修中心。维修中心的员工会帮您取出电池，并以环保的方式处理它。

卸下充电电池

只有在丢弃产品时才可取下充电电池。请确保在取下电池时电量已完全耗尽。

取出充电电池之后，不要再将本产品与电源相连。

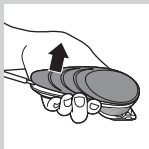

1 断开产品电源并让产品继续运行，直到马达停止。

2 去除产品的上顶盖部分。

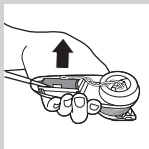

3 使用螺丝刀打开产品内部主体。

4 使用螺丝刀从产品取下充电电池。

5 使用家用剪刀剪断电线。

保修与服务

如果您需要服务或信息，或者有任何疑问，请访问飞利浦网站：www.philips.com/support。您也可与您所在国家/地区的飞利浦客户服务中心联系（可从全球保修卡中找到其电话号码）。如果您所在的国家/地区没有飞利浦客户服务中心，请与当地的飞利浦经销商联系。本产品所配备的电源适配器有2种规格，请以实物为准。

PHILIPS

产品 : 飞利浦自动理发器
型号 : QC5570
额定电压 : 220V~
额定频率 : 50Hz
额定输入功率: 7.5 W
生产日期 : 请见产品本体
产地 : 匈牙利



飞利浦电子香港有限公司
香港新界沙田香港科学园科技大道五号

经销单位: 飞利浦(中国)投资有限公司
上海市天目西路218号1602-1605
全国顾客服务热线: 4008 800 008

本产品依据国标 GB4706.1-2005, GB4706.9-2006
制造

请妥善保管本使用说明书
发行日期: 09/01/2013

PHILIPS

产品 : 飞利浦自动理发器
型号 : QC5570
额定电压 : 220V~
额定频率 : 50Hz
额定输入功率: 9 W
生产日期 : 请见产品本体
产地 : 匈牙利



飞利浦电子香港有限公司
香港新界沙田香港科学园科技大道五号

经销单位: 飞利浦(中国)投资有限公司
上海市天目西路218号1602-1605
全国顾客服务热线: 4008 800 008

本产品依据国标 GB4706.1-2005, GB4706.9-2006
制造

请妥善保管本使用说明书
发行日期: 09/01/2013



www.philips.com



100% recycled paper
100% papier recyclé
100% 循环再造纸

4222.002.8317.1